

IBD2GA

"Out Of Wall" Grille Access Fire Dampers

1 1/2 Hour UL555 Rated | For Static Systems



APPLICATION

IBD2GA are static fire dampers designed for "out of wall" applications. The damper and sleeve assembly can be installed completely from one side of the wall and does not require mounting angles on the backside. IBD2GA fire dampers are ideal for any grille application in which the damper cannot be installed in the wall. IBD2GA fire dampers can be configured for installation up to 8" (203) out of the wall and can be built with any transition; round, oval, rectangular, on the sleeve side opposite grille, for connection to ductwork.

STANDARD CONSTRUCTION

| | |
|--------------------------|--|
| Frame | Galvanized steel (in gauges required by UL listing R-5531). |
| Blades | Galvanized steel (in gauges required by UL listing R-5531). |
| Sleeve (Required) | Minimum 6" (152) 20 gauge (1.0) galvanized steel with 3/4" (19) Flange one end. Factory installed thermal blanket insulation around perimeter of sleeve. |
| Fusible Link | 165°F (74°C) is standard. 212°F (100°C) is available. |
| Mounting | Vertical. |

DAMPER SIZES

| | |
|---------------------|--|
| Minimum Size | Vertical Installation: Style A – 4"w x 4"h (102 x 102) |
| Maximum Size | Vertical Installation: Style A – 36"w x 36"h (914 x 914) |

OPTIONS

| |
|---|
| SP200 Switch Package to remotely indicate damper blade position |
| Greater Grille Depth – Consult Ruskin |
| Sleeves of various lengths and gauges to insure field compliance with UL installation requirements |
| Stainless Steel See IBD2SSGA |

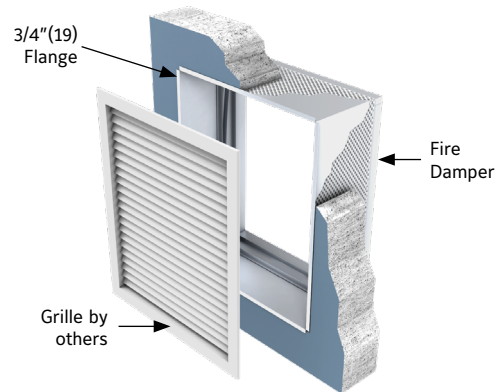

YEAR LIMITED WARRANTY

IBD2GA fire dampers meet the requirements for fire dampers established by:

- ▶ **National Fire Protection Association**
NFPA Standards 80, 90A, 92A, 92B and 101
- ▶ **ICC International Building Codes**
- ▶ **CSFM California State Fire Marshal**
Listing (#3225-0245:005)



SEE COMPLETE MARKING ON PRODUCT

UL CLASSIFIED
UL555 Listing R5531
ULCS112

Note:
- Damper furnished actual size to inside of sleeve.
- Dimensions shown in parentheses () indicate millimeters.

TYPICAL INSTALLATION

Wall opening

The opening in the wall shall be sized to accommodate the overall size of the damper, sleeve and insulation assembly. No expansion gap is required. For proper installation frame and finish the opening so it is 1/2" (13) larger in width and 1/2" (13) larger in height than the duct size.

For example a 24"w x 20"h (610 x 508) damper requires a wall opening of 24 1/2"w x 20 1/2"h (622 x 521). The damper/sleeve to duct connection remains 24"w x 20"h (610 x 508) and is the dimension used for grille considerations.

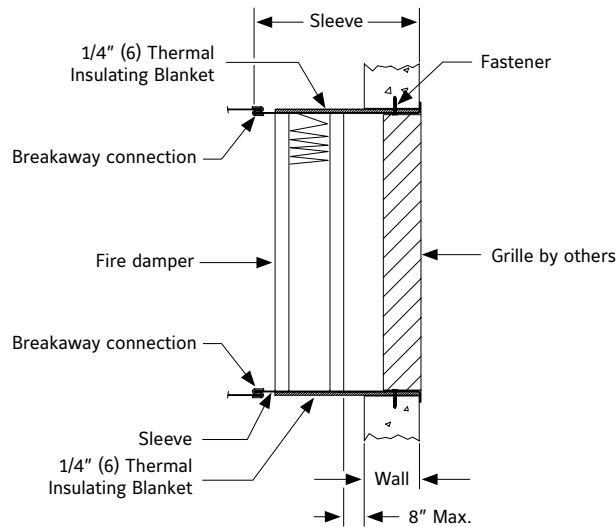

| Minimum Sleeve Length | | |
|-----------------------|---|---|
| Grille Depth | Minimum Sleeve Length Without Duct Connection | Minimum Sleeve Length With 2" Duct Connection |
| 1" (25.4) | 6" (152.4) | 8" (203.2) |
| 2" (50.8) | 7" (177.8) | 9" (228.6) |
| 3" (76.2) | 8" (203.2) | 10" (254) |
| 4" (101.6) | 9" (228.6) | 11" (279.4) |
| 5" (127) | 10" (254) | 12" (304.8) |
| 6" (152.4) | 11" (279.4) | 13" (330.2) |
| 7" (177.8) | 12" (304.8) | 14" (355.6) |
| 8" (203.2) | 13" (330.2) | 15" (381) |

LINKS TO IMPORTANT DOCUMENTS

Document Title

Limited Warranty Document



3900 Doctor Greaves Road
Grandview, MO 64030
Website: www.ruskin.com
Phone: (816) 761-7476