

## ELF22V STATIONARY LOUVER EXTRUDED ALUMINUM

### STANDARD CONSTRUCTION

#### FRAME

6063T5 extruded aluminum with .060" (1.5) nominal wall thickness.

#### BLADES

6063T5 extruded aluminum with .060" (1.5) nominal wall thickness. Chevron blades are spaced approximately 2" (51) center to center. Blades positioned at 60° angle.

#### SCREEN

5/8" x .040" (16 x 1) expanded, flattened aluminum bird screen. Screen adds approximately 1/2" (13) to louver depth.

#### FINISH

Mill.

#### MINIMUM SIZE

8"w x 8"h (203 x 203).

#### APPROXIMATE SHIPPING WEIGHT

4 lbs. per sq. ft. (20 kg/m<sup>2</sup>).

#### MAXIMUM SIZE

48"w x 96"h (1220 x 2438).

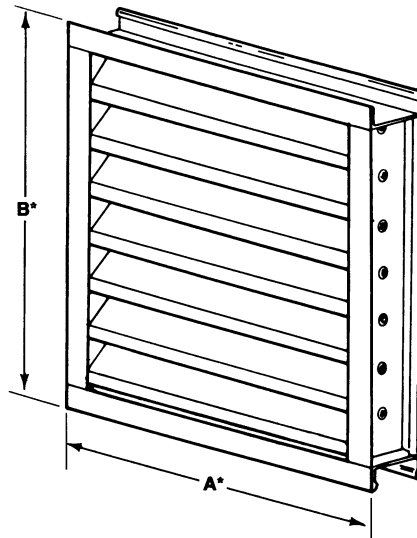

### FEATURES

The ELF22V offers:

- 28% free area (4' x 4' size).
- Corrosion resistant, aluminum construction.
- Outstanding durability and low maintenance.
- Sightproof chevron blades which provide privacy, conceal equipment, prevent vandalism, and act as a safety barrier to dangerous areas.

### VARIATIONS

Variations to the basic design of the louver are available at additional cost. They include:

- Extended sill.
- Flanged frame.
- Hinged frame.
- Front or rear security bars.
- Filter racks.
- A variety of bird and insect screens.
- Selection of finishes: baked enamel (modified fluoropolymer), epoxy, integral color and clear anodize, Pearledize and Kynar.

Consult Ruskin for other special requirements.

### FRAME CONSTRUCTION

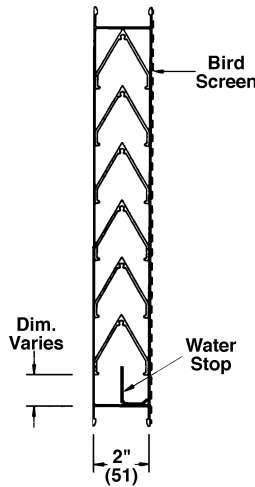
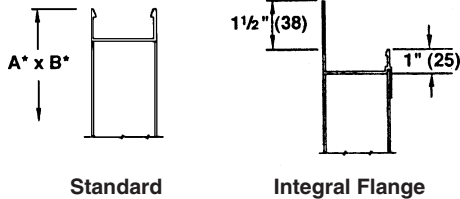

ELF22V

Dimensions in inches, parenthesis ( ) indicate millimeters.

\*Units furnished 1/4" (6) smaller than given opening dimensions.

QTY.	SIZE		FRAME	VARIATIONS
	A*-WIDE	B*-HIGH		
PROJECT			LOCATION	
CONTRACTOR				

## TYPICAL INSTALLATION DETAILS

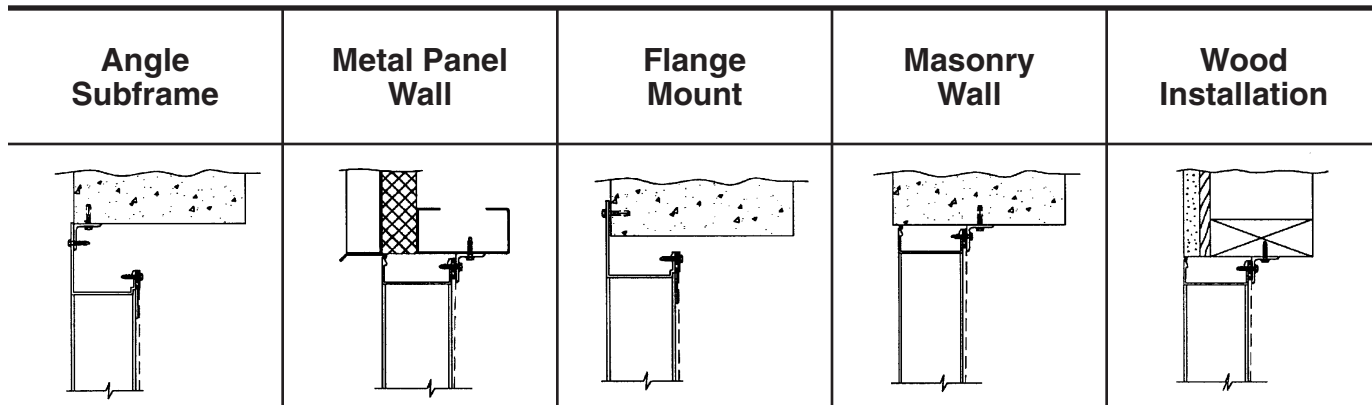

## FREE AREA GUIDE

Free Area Guide shows free area in ft<sup>2</sup> and m<sup>2</sup> for various sizes of ELF22V.

Width – Inches and Meters

	12	18	24	30	36	42	48
	.30	.46	.61	.76	.91	1.07	1.22
<b>12</b>	<b>0.18</b>	<b>0.30</b>	<b>0.42</b>	<b>0.54</b>	<b>0.66</b>	<b>0.78</b>	<b>0.90</b>
.30	.02	.03	.04	.05	.06	.07	.08
<b>18</b>	<b>0.30</b>	<b>0.49</b>	<b>0.69</b>	<b>0.89</b>	<b>1.09</b>	<b>1.09</b>	<b>1.48</b>
.46	.03	.05	.06	.08	.10	.12	.14
<b>24</b>	<b>0.41</b>	<b>0.69</b>	<b>0.97</b>	<b>1.24</b>	<b>1.52</b>	<b>1.79</b>	<b>2.07</b>
.61	.04	.06	.09	.12	.14	.17	.19
<b>30</b>	<b>0.53</b>	<b>0.89</b>	<b>1.24</b>	<b>1.59</b>	<b>1.95</b>	<b>2.30</b>	<b>2.66</b>
.76	.05	.08	.12	.15	.18	.21	.25
<b>36</b>	<b>0.65</b>	<b>1.08</b>	<b>1.51</b>	<b>1.95</b>	<b>2.38</b>	<b>2.81</b>	<b>3.24</b>
.91	.06	.10	.14	.18	.22	.26	.30
<b>42</b>	<b>0.77</b>	<b>1.28</b>	<b>1.79</b>	<b>2.30</b>	<b>2.81</b>	<b>3.32</b>	<b>3.83</b>
1.07	.07	.12	.17	.21	.26	.31	.36
<b>48</b>	<b>0.88</b>	<b>1.47</b>	<b>2.06</b>	<b>2.65</b>	<b>3.24</b>	<b>3.83</b>	<b>4.41</b>
1.22	.08	.14	.19	.25	.30	.36	.41
<b>54</b>	<b>1.00</b>	<b>1.67</b>	<b>2.33</b>	<b>3.00</b>	<b>3.67</b>	<b>4.33</b>	<b>5.00</b>
1.37	.09	.16	.22	.28	.34	.40	.46
<b>60</b>	<b>1.12</b>	<b>1.86</b>	<b>2.61</b>	<b>3.35</b>	<b>4.10</b>	<b>4.84</b>	<b>5.59</b>
1.52	.10	.17	.24	.31	.38	.45	.52
<b>66</b>	<b>1.23</b>	<b>2.06</b>	<b>2.88</b>	<b>3.70</b>	<b>4.53</b>	<b>5.35</b>	<b>6.17</b>
1.68	.11	.19	.27	.34	.42	.50	.57
<b>72</b>	<b>1.35</b>	<b>2.25</b>	<b>3.15</b>	<b>4.05</b>	<b>4.96</b>	<b>5.86</b>	<b>6.76</b>
1.83	.13	.21	.29	.38	.46	.54	.63
<b>78</b>	<b>1.47</b>	<b>2.45</b>	<b>3.43</b>	<b>4.41</b>	<b>5.39</b>	<b>6.36</b>	<b>7.34</b>
1.98	.14	.23	.32	.41	.50	.59	.68
<b>84</b>	<b>1.59</b>	<b>2.64</b>	<b>3.70</b>	<b>4.76</b>	<b>5.82</b>	<b>6.87</b>	<b>7.93</b>
2.13	.15	.25	.34	.44	.54	.64	.74
<b>90</b>	<b>1.70</b>	<b>2.84</b>	<b>3.97</b>	<b>5.11</b>	<b>6.25</b>	<b>7.38</b>	<b>8.52</b>
2.29	.16	.26	.37	.47	.58	.69	.79
<b>96</b>	<b>1.82</b>	<b>3.03</b>	<b>4.25</b>	<b>5.46</b>	<b>6.67</b>	<b>7.89</b>	<b>9.10</b>
2.44	.17	.28	.39	.51	.62	.73	.85
<b>102</b>	<b>1.94</b>	<b>3.23</b>	<b>4.52</b>	<b>5.81</b>	<b>7.10</b>	<b>8.40</b>	<b>9.69</b>
2.59	.18	.30	.42	.54	.66	.78	.90
<b>108</b>	<b>2.05</b>	<b>3.42</b>	<b>4.79</b>	<b>6.16</b>	<b>7.53</b>	<b>8.90</b>	<b>10.27</b>
2.74	.19	.32	.45	.57	.70	.83	.95
<b>114</b>	<b>2.17</b>	<b>3.62</b>	<b>5.07</b>	<b>6.52</b>	<b>7.96</b>	<b>9.41</b>	<b>10.86</b>
2.90	.20	.34	.47	.61	.74	.87	1.01
<b>120</b>	<b>2.29</b>	<b>3.82</b>	<b>5.34</b>	<b>6.87</b>	<b>8.39</b>	<b>9.92</b>	<b>11.45</b>
3.05	.21	.35	.50	.64	.78	.92	1.06

# RUSKIN®

3900 Dr. Greaves Rd.  
 Kansas City, MO 64030  
 (816) 761-7476  
 FAX (816) 765-8955  
[www.ruskin.com](http://www.ruskin.com)