



**ACOUSTICAL DIFFUSER
FOR VANE AXIAL FAN
MODEL XFA
Submittal Sheet**

3900 Dr. Greaves Rd., Kansas City, MO 64030 • Phone (816) 761-7476 • FAX (816) 763-0986 • Email: info@ruskinsound.com • Website: ruskinsound.com

MODEL DESIGNATION			
MODEL	Fan Size 'A'	Length 'C'	Fan Hub 'D'
XFA	(Inches)	(Inches)	(Inches)

Example: XFA 24" 46" To Match

CONSTRUCTION STANDARDS

18 gage (1.3) galvanized steel outer shell. Internal baffles constructed of 22 gage (.90) perforated galvanized steel and filled with inorganic glass fiber acoustic material. Fiber packed under 5% compression to eliminate voids due to settling. Silencers capable of withstanding a differential air pressure of 8" w.g. Diameters "A" and "A-A" extend past outer shell 2" (51) on each end. Static pressure drop values have been measured in accordance with ASTM E-477 testing standards.

Incombustible filler material exhibits the following fire hazard classification value when tested in accordance with standard ASTM E84, NFPA 255, or UL-723 test methods:

FLAMESPREAD20
FUEL CONTRIBUTED15
SMOKE DEVELOPED20

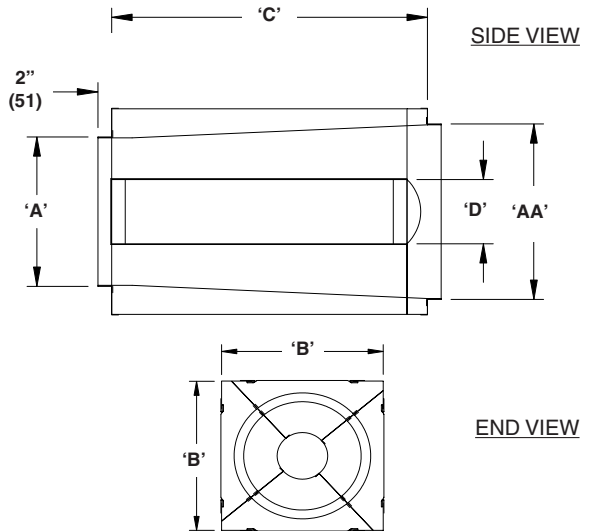

Fan Hook Up at "A"

DYNAMIC INSERTION LOSS dB

Model	Rated Velocity FPM	Forward/Reverse	OCTAVE BAND/CENTER FREQUENCY (HZ)									
			1	2	3	4	5	6	7	8		
			63	125	250	500	1000	2000	4000	8000		

SCHEDULE

Mark	Qty.	Model	Dia. (A)	A-A	B	C	D*	CFM	SP	FPM	Variations

*Center bullet sized to match fan hub (required dimension).

VARIATIONS: ① 1 1/2" Flange one end ② 1 1/2" Flange both ends ③ Standard flange bolt holes ④ Custom flange bolt holes ⑤ G90 construction ⑥ 304 Stainless Steel ⑦ 316 Stainless steel ⑧ 16ga shell ⑨ 14ga shell ⑩ 12ga shell ⑪ 10ga HTL shell (STC45) ⑫ Mineral Wool ⑬ Natural Fiber ⑭ Fiberglass Cloth Lining ⑮ Mylar Lining ⑯ Tedlar Lining ⑰ Mylar Bag ⑱ Tedlar Bag ⑲ Stand-off ⑳ Shrink wrap for ship



3900 Dr. Greaves Rd.
Kansas City, MO 64030
(816) 761-7476
FAX (816) 763-0986
<http://www.ruskinsound.com>

Printed on recycled paper
using vegetable based inks

