

## TDF AND TDC FIELD ADD-ON CONNECTIONS INSTALLATION INSTRUCTIONS SUPPLEMENT

### GENERAL INSTALLATION

TDF and TDC flanged connections are designed to be roll-formed into the end of the duct or damper sleeve at the time of damper manufacture. If that is not possible, TDF and TDC can be added in the field in accordance with the installation diagram and notes shown below.

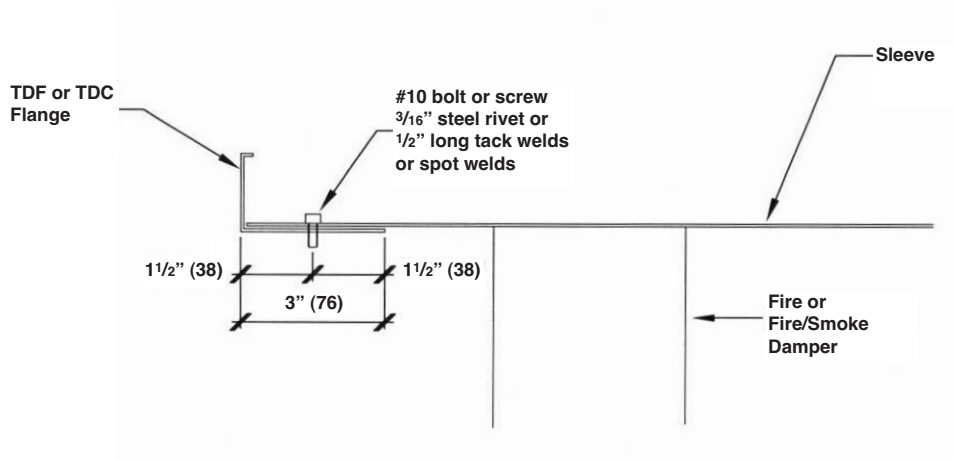

**IMPORTANT NOTE:** The add-on piece of TDF or TDC must be “sealed” to the existing sleeve with one of the following approved break-away sealants:

Hardcast, Inc. - Iron Grip 601  
Ecp Duct Seal 44-52

Precision - PA2084T  
Design Polymeric - DP 1010

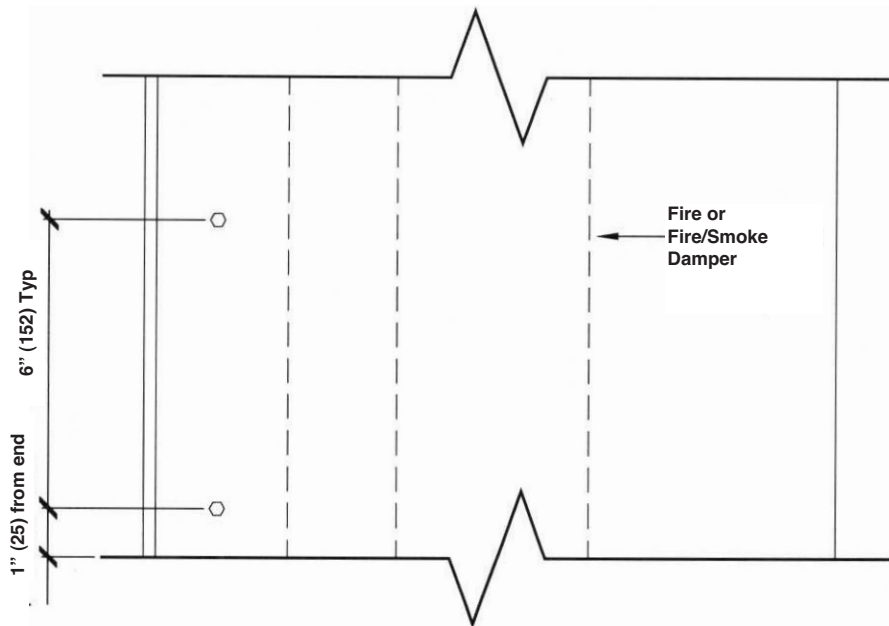

**NOTE:** Dimensions in ( ) indicate millimeters.

***RUSKIN***®

3900 Dr. Greaves Rd.  
Kansas City, MO 64030  
(816) 761-7476  
FAX (816) 765-8955  
[www.ruskin.com](http://www.ruskin.com)