

# MODEL IAQ50X ORDER PROCESS SHEET

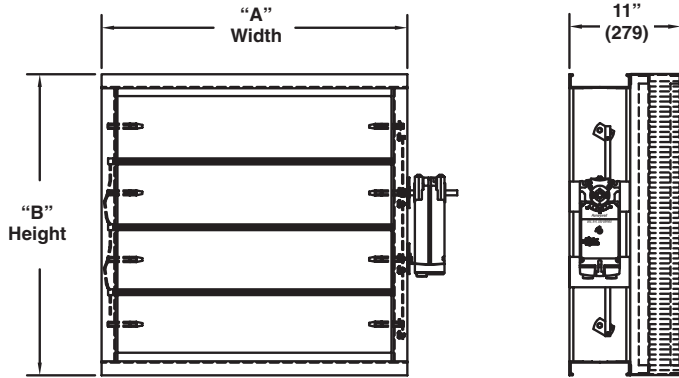

Typical "MC1" configuration shown with standard Code "E" actuator mounting and no flange "NF"

**NOTES:**  
Standard features will be assumed unless otherwise indicated.

The IAQ50X is available in two basic mounting configurations (Minimum and full). Minimum units are available top & bottom or side by side. Specify the correct mounting configuration (MC1, MC2 or MC3). Order the adjacent damper separately and note in comments section.

- DEDUCT 1/4" (Standard for Slip-Fit)
- ACTUAL SIZE

Note: Flange mount units may be deduct or actual (please specify)

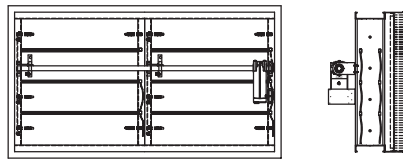
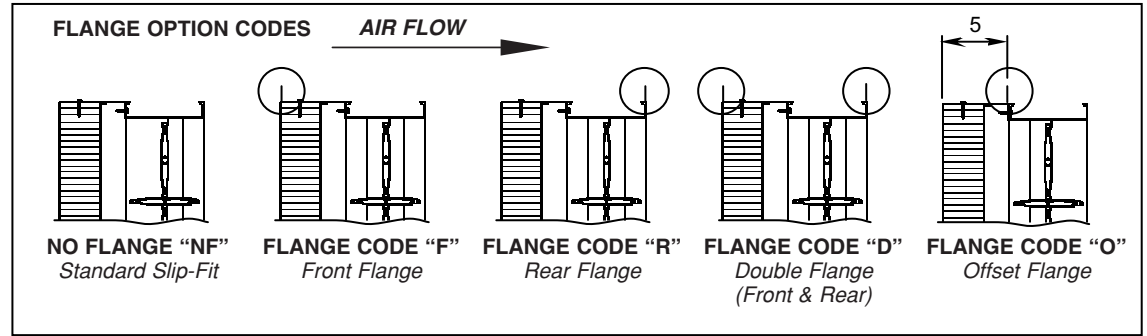

**ACTUATOR MOUNTING CODE "I"**  
Internal Mount (only on jackshaft)

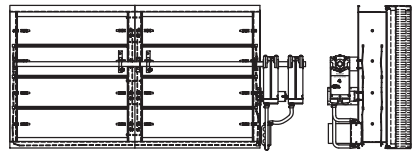

**ACTUATOR MOUNTING CODE "E" (STANDARD)**  
External Mount (jackshaft on multiple sections only)

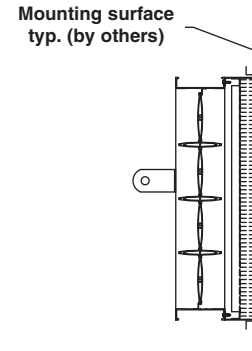

**CODE MC1**  
Full (Standard)

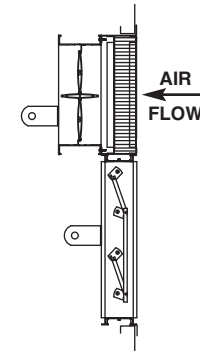

**CODE MC2**  
Top & Bottom

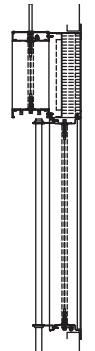

**CODE MC3**  
Side by Side

**MOUNTING CONFIGURATION CODES**  
All Shown with Flange code "F"

Jamb Seals	Mounting Config.	Actuator	Control & Accessories				Flange	Flange Location (see details above)
Stn. Stl.	Full (Std.) "MC1"	Code "E"	Calibrated Control Package (Std.)				None (Std.)	None (Std.) Slip-Fit Applications Code "NF"
Blade Seals	Top & Bottom "MC2"	Code "I"	(Includes Actuator & Controller with calibration)				1/2"	Front Flange Code "F"
Ruskiprene	Side by Side "MC3"	Fail Position	Mount adjacent damper (MC2 or MC3 Units only)				1"	Rear Flange Code "R"
Vert. Blades	Linkage	Closed (Std)	Mount Louver (specify model in additional comments)				1 1/2"	Double Flange Code "D"
No (Std.)	Plated Steel (Std.)	Open					2"	5" Offset Flange Code "O"
Yes	300 Series Stn. Stl.						2 1/2"	

Qty	Model	Width A Dim	Height B Dim	Design CFM	Low Limit CFM	High Limit CFM	Unit Tag	Additional Comments