

## ELF211 THIN LINE STATIONARY LOUVER EXTRUDED ALUMINUM

### STANDARD CONSTRUCTION

#### FRAME

2" (51) deep 6063T5 extruded aluminum with .060" (1.5) nominal wall thickness. Caulking surfaces provided.

#### BLADES

6063T5 extruded aluminum with .060" (1.5) nominal wall thickness. Blades are positioned at 45° angle and spaced approximately 3<sup>3</sup>/<sub>16</sub>" (81) center to center.

#### SCREEN

3/4" x .051" (19 x 1.3) expanded, flattened aluminum bird screen in removable frame. Screen adds approximately 1/2" (13) to louver depth.

#### FINISH

Mill.

#### MINIMUM SIZE

6"w x 10"h (152 x 254).

#### APPROXIMATE SHIPPING WEIGHT

2 lbs. per sq. ft. (9.8 kg/m<sup>2</sup>).

#### MAXIMUM SIZE

Shall be 75 sq. ft. (7m<sup>2</sup>) per section, not to exceed 120"w x 90"h (3048 x 2286) or 90"w x 120"h (2286 x 3048).

Louvers larger than the maximum factory assembly size will require field assembly of smaller sections.

#### SUPPORTS

Louvers may be provided with rear mounted blade supports that increase overall louver depth depending on louver size, assembly configuration or windload.

Consult Ruskin for additional information.

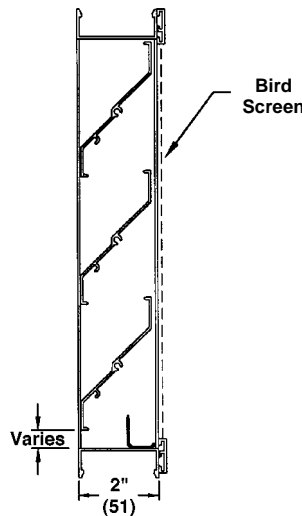
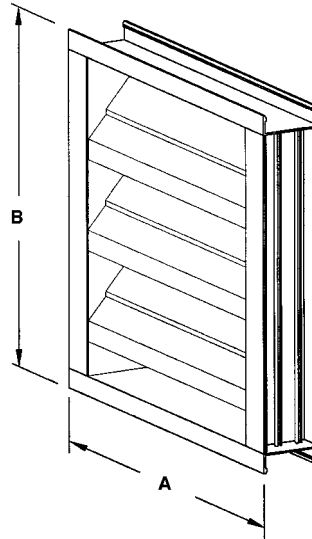

### FEATURES

The ELF211 offers:

- 42% Free Area.
- Published performance ratings based on testing in accordance with AMCA Standard 500.
- Aluminum construction for low maintenance and high resistance to corrosion.

### VARIATIONS

Variations to the basic design of the louver are available at additional cost. They include:

- Extended sill.
- Hinged frame.
- Front or rear security bars.
- Filter racks.
- Installation angles.
- A variety of bird and insect screens.
- Selection of finishes: prime coat, baked enamel (modified fluoropolymer), epoxy, Acrodize, Kynar, clear and color anodize. (Some variation in anodize color consistency is possible.)

Consult Ruskin for other special requirements.

### FRAME CONSTRUCTION

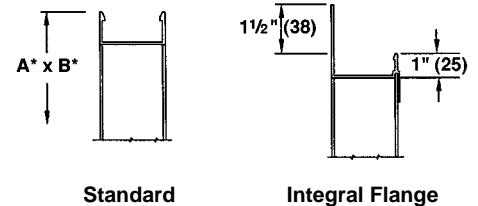

Dimensions in inches, parenthesis ( ) indicate millimeters.

\*Units furnished 1/4" (6) smaller than given opening dimensions.

TAG	QTY.	SIZE		FRAME	VARIATIONS
		A*-WIDE	B*-HIGH		
PROJECT ARCH./ENGR. REPRESENTATIVE			LOCATION CONTRACTOR DATE		

# TYPICAL INSTALLATION DETAILS

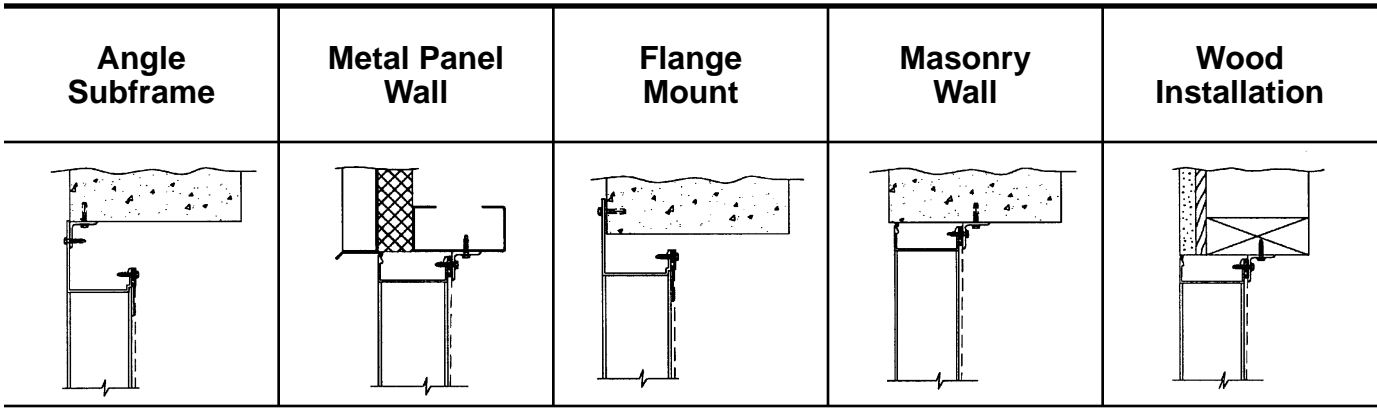

# STANDARD CONSTRUCTION DETAILS

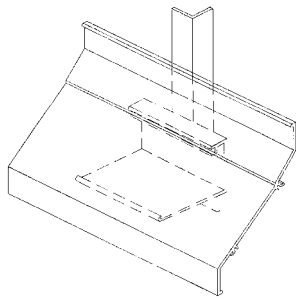

Hidden Vertical Blade Support (HVBS)

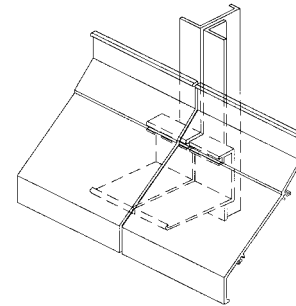

Continuous Blade Appearance at Multiple Section Junctions

## PRESSURE DROP

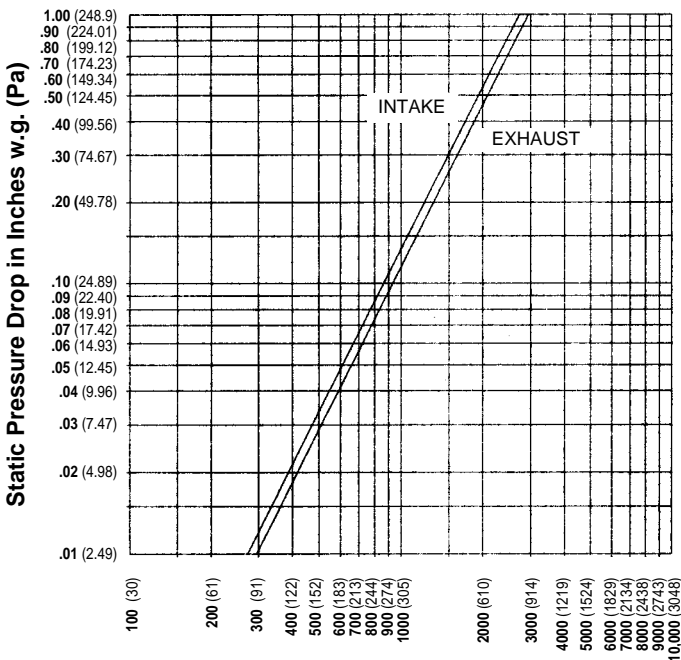

Free Area Velocity in feet (meters) per minute through free area.

## FREE AREA GUIDE

Free Area Guide shows free area in ft<sup>2</sup> and m<sup>2</sup> for various sizes of ELF211  
Width – Inches and Meters

	12	18	24	30	36	42	48	54	60
	0.30	0.46	0.61	0.76	0.91	1.07	1.22	1.37	1.52
<b>12</b>	<b>0.26</b>	<b>0.41</b>	<b>0.56</b>	<b>0.71</b>	<b>0.86</b>	<b>1.01</b>	<b>1.16</b>	<b>1.31</b>	<b>1.46</b>
0.30	0.02	0.04	0.05	0.07	0.08	0.09	0.11	0.12	0.14
<b>18</b>	<b>0.45</b>	<b>0.71</b>	<b>0.96</b>	<b>1.22</b>	<b>1.48</b>	<b>1.73</b>	<b>1.99</b>	<b>2.25</b>	<b>2.50</b>
0.46	0.04	0.07	0.09	0.11	0.14	0.16	0.19	0.21	0.23
<b>24</b>	<b>0.76</b>	<b>1.20</b>	<b>1.63</b>	<b>2.07</b>	<b>2.50</b>	<b>2.94</b>	<b>3.37</b>	<b>3.81</b>	<b>4.24</b>
0.61	0.07	0.11	0.15	0.19	0.23	0.27	0.31	0.35	0.39
<b>30</b>	<b>0.95</b>	<b>1.49</b>	<b>2.03</b>	<b>2.57</b>	<b>3.12</b>	<b>3.66</b>	<b>4.20</b>	<b>4.74</b>	<b>5.29</b>
0.76	0.09	0.14	0.19	0.24	0.29	0.34	0.39	0.44	0.49
<b>36</b>	<b>1.14</b>	<b>1.78</b>	<b>2.43</b>	<b>3.08</b>	<b>3.73</b>	<b>4.38</b>	<b>5.03</b>	<b>5.68</b>	<b>6.33</b>
0.91	0.11	0.17	0.23	0.29	0.35	0.41	0.47	0.53	0.59
<b>42</b>	<b>1.32</b>	<b>2.08</b>	<b>2.83</b>	<b>3.59</b>	<b>4.35</b>	<b>5.10</b>	<b>5.86</b>	<b>6.61</b>	<b>7.37</b>
1.07	0.05	0.08	0.11	0.14	0.17	0.20	0.23	0.26	0.29
<b>48</b>	<b>1.51</b>	<b>2.37</b>	<b>3.23</b>	<b>4.10</b>	<b>4.96</b>	<b>5.82</b>	<b>6.69</b>	<b>7.55</b>	<b>8.41</b>
1.22	0.14	0.22	0.30	0.38	0.46	0.54	0.62	0.70	0.78
<b>54</b>	<b>1.70</b>	<b>2.67</b>	<b>3.64</b>	<b>4.60</b>	<b>5.57</b>	<b>6.54</b>	<b>7.51</b>	<b>8.48</b>	<b>9.45</b>
1.37	0.16	0.25	0.34	0.43	0.52	0.61	0.70	0.79	0.88
<b>60</b>	<b>1.88</b>	<b>2.96</b>	<b>4.04</b>	<b>5.11</b>	<b>6.19</b>	<b>7.26</b>	<b>8.34</b>	<b>9.42</b>	<b>10.49</b>
1.52	0.18	0.28	0.38	0.48	0.58	0.68	0.78	0.88	0.98
<b>66</b>	<b>2.20</b>	<b>3.45</b>	<b>4.71</b>	<b>5.96</b>	<b>7.21</b>	<b>8.47</b>	<b>9.72</b>	<b>10.98</b>	<b>12.23</b>
1.68	0.20	0.32	0.44	0.55	0.67	0.79	0.90	1.02	1.14
<b>72</b>	<b>2.38</b>	<b>3.74</b>	<b>5.11</b>	<b>6.47</b>	<b>7.83</b>	<b>9.19</b>	<b>10.55</b>	<b>11.91</b>	<b>13.27</b>
1.83	0.22	0.35	0.47	0.60	0.73	0.85	0.98	1.11	1.23

Height – Inches and Meters



3900 Dr. Greaves Rd.  
Kansas City, MO 64030  
(816) 761-7476  
FAX (816) 765-8955  
www.ruskin.com