

ELM6375DX DRAINABLE ADJUSTABLE LOUVER EXTRUDED ALUMINUM

STANDARD CONSTRUCTION

FRAME

6" (152) deep, 6063T5 extruded aluminum with .081" (2.1) nominal wall thickness. Downspouts and caulking surfaces provided.

BLADES

6063T5 extruded aluminum, .081" (2.1) nominal wall thickness. Drainable blades are adjustable to a 37 1/2° angle and blade spacing is approximately 6" (152) center to center.

SCREEN

5/8" x .040 (16 x 1) expanded, flattened aluminum bird screen in removable frame. Screen adds approximately 1/2" (13) to louver depth.

SEALS

Flexible, compressible aluminum jamb seals.

BEARINGS

Stainless steel sleeve pressed into frame.

AXLES

1/2" (13) plated steel hex.

FINISH

Mill.

LINKAGE

Concealed in frame.

ACTUATOR

Locking louver quadrant

MINIMUM SIZE

12" w x 12" h (305x305).

APPROXIMATE SHIPPING WEIGHT

3.5 lbs. / ft.² (17.1 kg per m²)

MAXIMUM FACTORY ASSEMBLY SIZE

Shall be 60" x 96" (1524x2438) without seals. Louvers with standard jamb seals and/or optional blade seals shall be 48"x96" (1219x2438). Standard construction includes jamb seals. Louvers larger than the maximum factory assembly size will require field assembly of smaller sections.

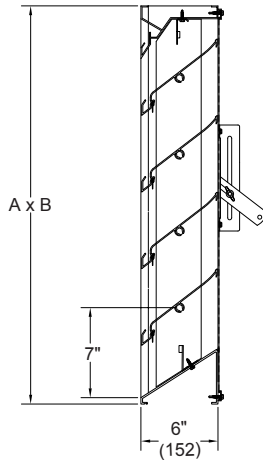

FEATURES

The ELM6375DX offers:

- Published performance ratings based on testing in accordance with AMCA Publication 500-L.
- Low torque operation and architecturally pleasing appearance with low leakage performance.
- Drain gutter in the head frame and each blade; downspouts in jambs and mullions to drain water from louver for minimum water cascade from blade to blade.
- Concealed blade linkage is protected from weather exposure and reduces required installation depth.
- Jamb seals provide tight blade-to-frame closure.

VARIATIONS

Variations to the basic design of this louver are available at additional cost. They include:

- Extended sill.
- Front or rear security bars.
- Filter racks.
- Blade edge seals.
- A variety of bird and insect screens.
- Selection of finishes: prime coat, baked enamel (modified fluoropolymer), epoxy, Acrodize, Kynar, clear and color anodize. (Some variation in anodize color consistency is possible.)
- Manual, electric or pneumatic actuators.

Consult Ruskin for other special requirements.

FRAME CONSTRUCTION

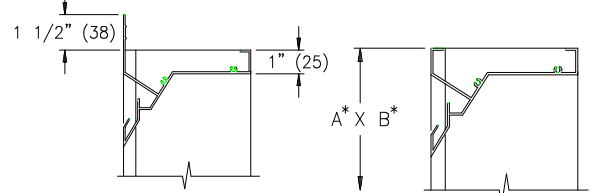

INTEGRAL FLANGE

STANDARD

Dimensions in inches, parentheses () indicate millimeters.

*Units furnished 1/4" (6) smaller than given opening dimensions.

TAG	QTY	SIZE		FRAME	VARIATIONS
		A* - WIDE	B* - HIGH		
PROJECT ARCH. /ENGR. REPRESENTATIVE				LOCATION CONTRACTOR DATE	

PERFORMANCE DATA

AMCA Standard 500 provides a reasonable basis for testing and rating louvers. Testing to AMCA 500 is performed under a certain set of laboratory conditions. This does not guarantee that other conditions will not occur in the actual environment where louvers must operate.

The louver system should be designed with a reasonable safety factor for louver performance. To ensure protection from water carryover, design with a performance level somewhat below maximum desired pressure drop and .01 oz. /sq. ft. of water penetration.

WATER PENETRATION

Test size 48" wide x48" high (1219 x 1219)

Beginning point of water penetration at .01 oz. /sq. ft. is 1157 fpm (352 m/min.)

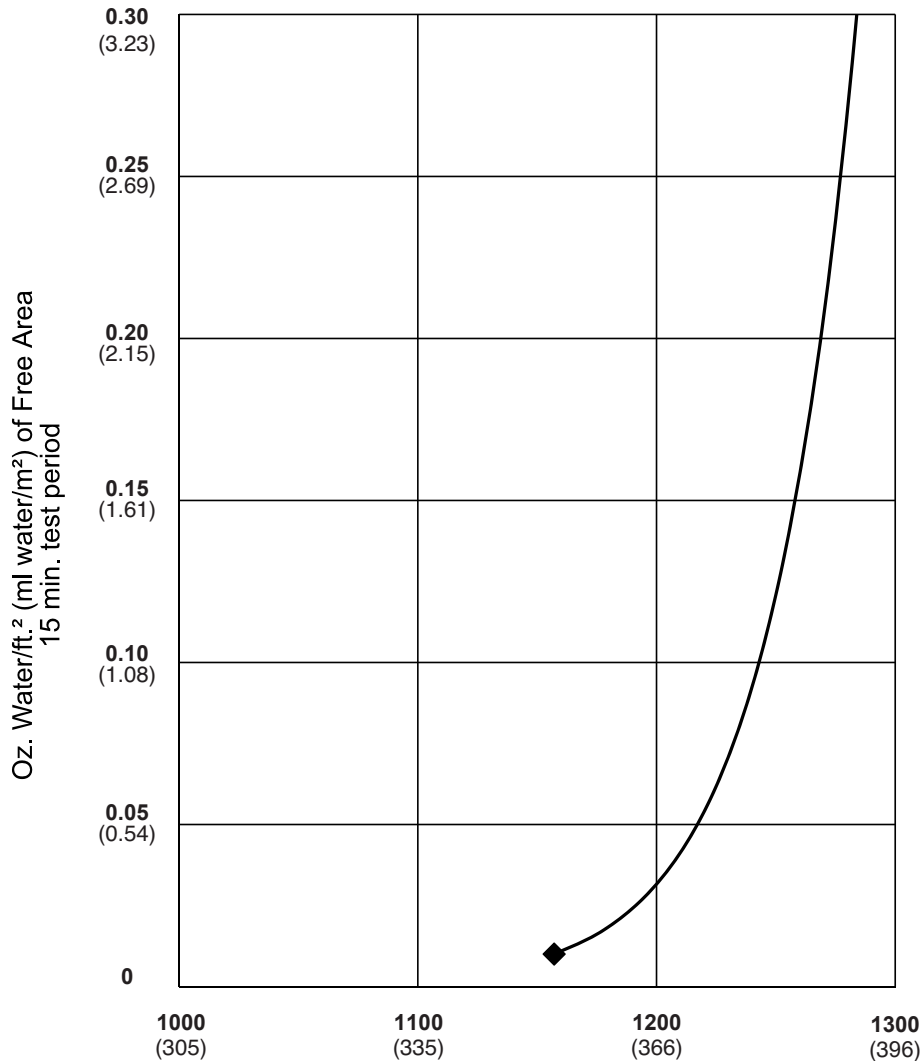

Ruskin Company certifies that the ELM6375DX louvers shown herein are licensed to bear the AMCA Seal. The ratings shown are based on tests and procedures performed in accordance with AMCA Publication 511 and comply with the requirements of the AMCA Certified Ratings Program. The AMCA Certified Ratings Seal applies to air performance ratings and water penetration ratings only.

Free Area Velocity in feet (meters) per minute
Standard air .075 lb. /ft.³ (1.2 kg/m³)

ALL STATED SPECIFICATIONS ARE SUBJECT TO CHANGE
WITHOUT NOTICE OR OBLIGATION

PRESSURE DROP
Test size 48" x 48" (1219 x 1219)
 Ratings do not include the effect of a bird screen.

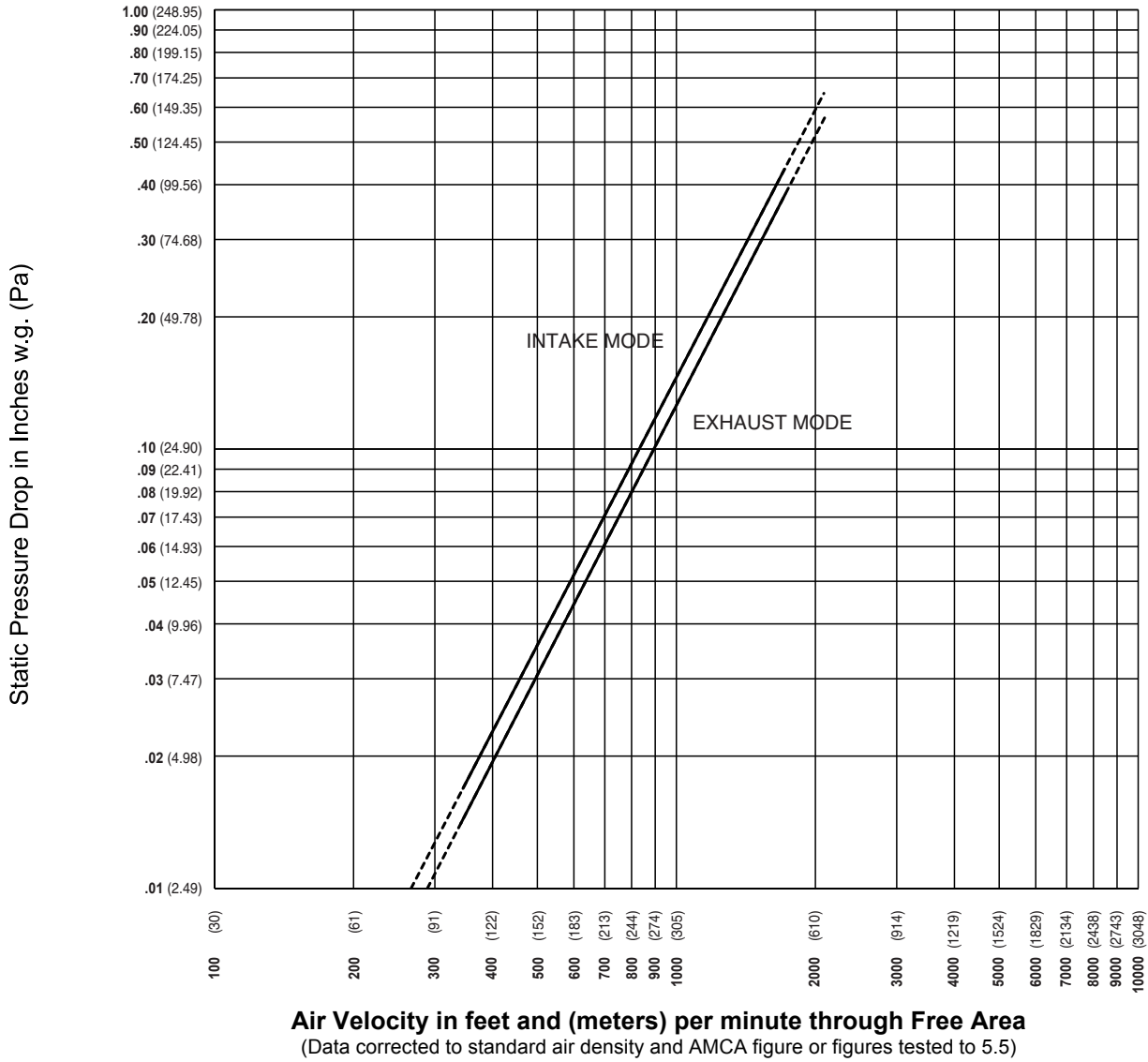

**ALL STATED SPECIFICATIONS ARE SUBJECT TO CHANGE
 WITHOUT NOTICE OR OBLIGATION**

AIR LEAKAGE WITH BLADES CLOSED

Leakage at 1" w.g. (248.9) static pressure drop is **10.8 CFM per ft.²** and (m²).

Louver tested for air leakage with jamb seals and optional blade seals.

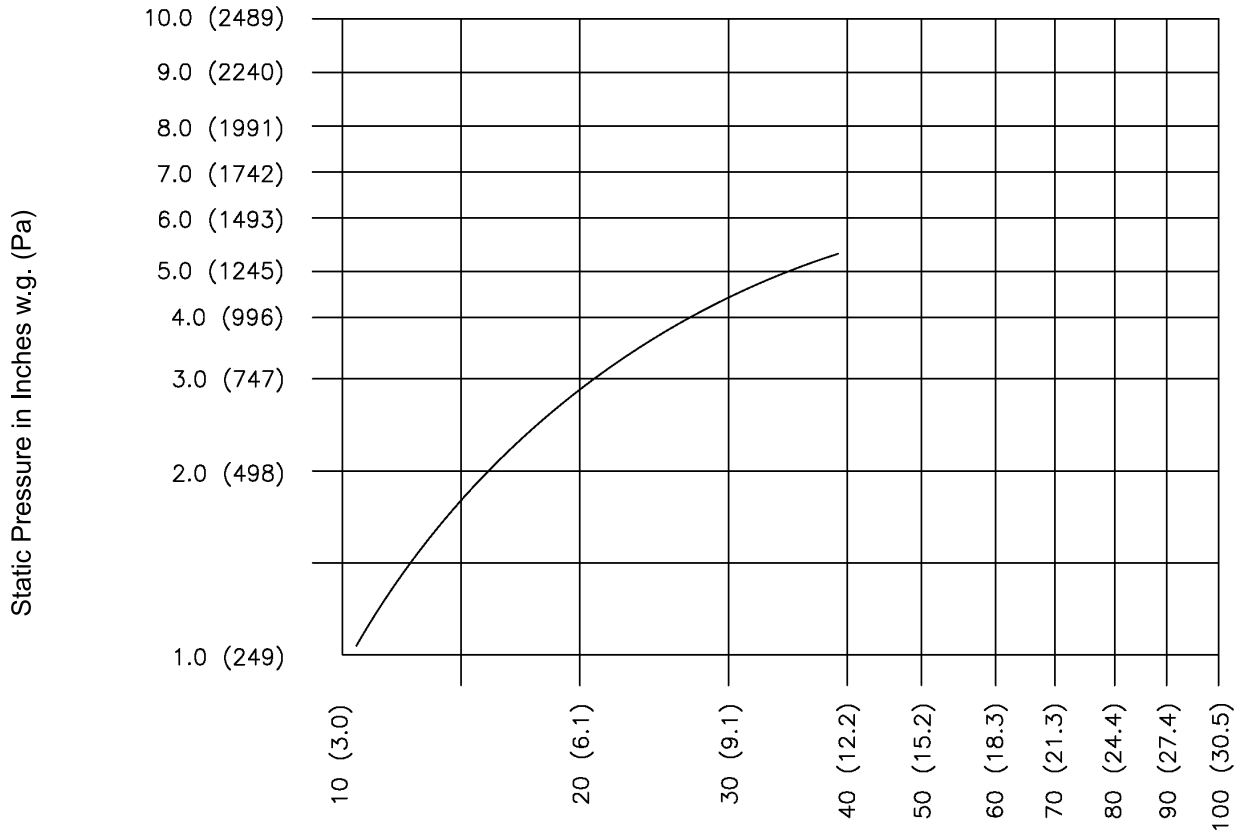

CFM (m³/min) Leakage per ft.² (m²) of Face Area

Data corrected to standard air density

FREE AREA GUIDE

Free Area Guide shows free area in ft² and m² for various sizes of ELM6375DX
Width – Inches and Meters

	12	18	24	30	36	42	48	54	60
	0.30	0.46	0.61	0.76	0.91	1.07	1.22	1.37	1.52
12	0.27	0.43	0.58	0.74	0.90	1.06	1.22	1.38	1.54
0.30	0.02	0.04	0.05	0.07	0.08	0.10	0.11	0.13	0.14
18	0.54	0.87	1.20	1.52	1.85	2.18	2.50	2.83	3.16
0.46	0.05	0.08	0.11	0.14	0.17	0.20	0.23	0.26	0.29
24	0.82	1.32	1.81	2.30	2.80	3.29	3.79	4.28	4.77
0.61	0.08	0.12	0.17	0.21	0.26	0.31	0.35	0.40	0.44
30	1.10	1.76	2.42	3.08	3.74	4.41	5.07	5.73	6.39
0.76	0.10	0.16	0.23	0.29	0.35	0.41	0.47	0.53	0.59
36	1.38	2.21	3.04	3.86	4.69	5.52	6.35	7.18	8.00
0.91	0.13	0.21	0.28	0.36	0.44	0.51	0.59	0.67	0.74
42	1.66	2.65	3.65	4.64	5.64	6.63	7.63	8.62	9.62
1.07	0.15	0.25	0.34	0.43	0.52	0.62	0.71	0.80	0.89
48	1.94	3.10	4.26	5.42	6.59	7.75	8.91	10.07	11.23
1.22	0.18	0.29	0.40	0.50	0.61	0.72	0.83	0.94	1.04
54	2.22	3.54	4.87	6.20	7.53	8.86	10.19	11.52	12.85
1.37	0.21	0.33	0.45	0.58	0.70	0.82	0.95	1.07	1.19
60	2.49	3.99	5.49	6.98	8.48	9.98	11.47	12.97	14.46
1.52	0.23	0.37	0.51	0.65	0.79	0.93	1.07	1.21	1.35
66	2.77	4.44	6.10	7.76	9.43	11.09	12.75	14.42	16.08
1.68	0.26	0.41	0.57	0.72	0.88	1.03	1.19	1.34	1.50
72	3.05	4.88	6.71	8.54	10.37	12.20	14.03	15.86	17.70
1.83	0.28	0.45	0.62	0.79	0.96	1.13	1.31	1.48	1.65
78	3.33	5.33	7.32	9.32	11.32	13.32	15.32	17.31	19.31
1.98	0.31	0.50	0.68	0.87	1.05	1.24	1.42	1.61	1.80
84	3.61	5.77	7.94	10.10	12.27	14.43	16.60	18.76	20.93
2.13	0.34	0.54	0.74	0.94	1.14	1.34	1.54	1.74	1.95
90	3.89	6.22	8.55	10.88	13.21	15.55	17.88	20.21	22.54
2.29	0.36	0.58	0.80	1.01	1.23	1.45	1.66	1.88	2.10
96	96.00	4.17	6.66	9.16	11.66	14.16	16.66	19.16	21.66
2.44	8.93	0.39	0.62	0.85	1.08	1.32	1.55	1.78	2.01

Height – Inches and Millimeters

**ALL STATED SPECIFICATIONS ARE SUBJECT TO CHANGE
WITHOUT NOTICE OR OBLIGATION**

TYPICAL INSTALLATION DETAILS

Masonry Wall

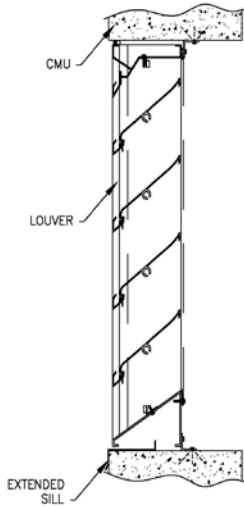

Metal Panel Wall

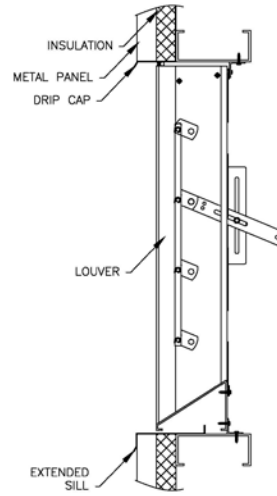

Wood Installation

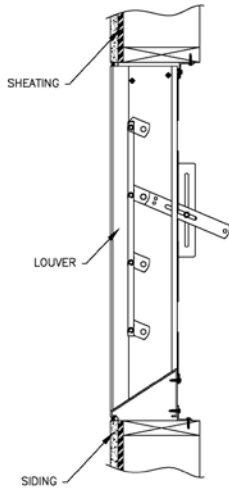

Flange Mount

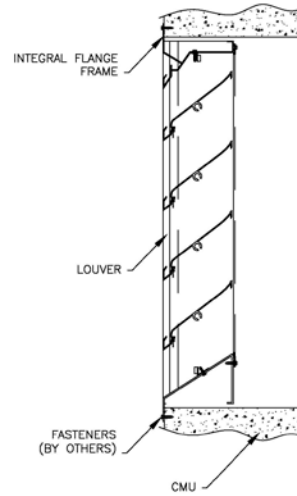

RUSKIN[®]

3900 Dr. Greaves Rd.
Kansas City, MO 64030
(816) 761-7476
FAX (816) 765-8955

**ALL STATED SPECIFICATIONS ARE SUBJECT TO CHANGE
WITHOUT NOTICE OR OBLIGATION**