

GFL800 STATIONARY LOUVER EXTRUDED ALUMINUM

STANDARD CONSTRUCTION

FRAME

4" (102) deep, 6063T5 extruded aluminum with .080" (2) nominal wall thickness. Box or integral flange frames are available. Caulking slots provided on box frame.

BLADES

6063T5 extruded aluminum with .063" (1.6) nominal wall thickness. J-style blades (formerly "weatherproof") are positioned at 45° angle and spaced approximately 5" (127) center to center.

SCREEN

3/4" x .051" (19 x 1.3) expanded, flattened aluminum bird screen in removable frame. Screen adds approximately 1/2" (13) to louver depth.

FINISH

Mill.

MINIMUM SIZE

12"w x 12"h (305 x 305).

MAXIMUM SIZE

60"w x 60"h (1524 x 1524).

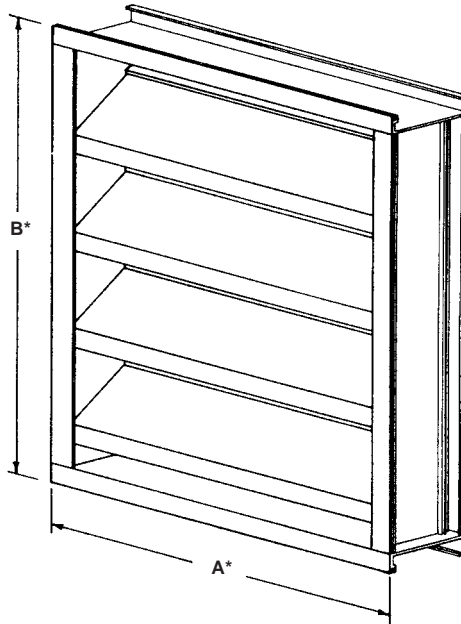

SUGGESTED INSTALLATION DETAILS

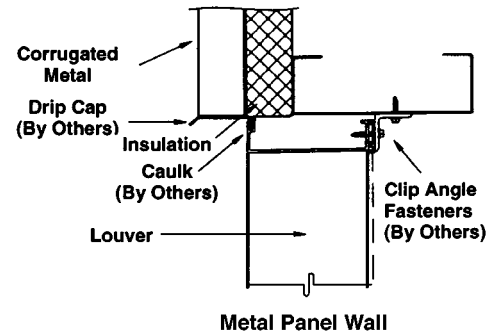
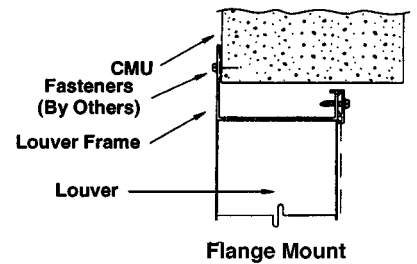
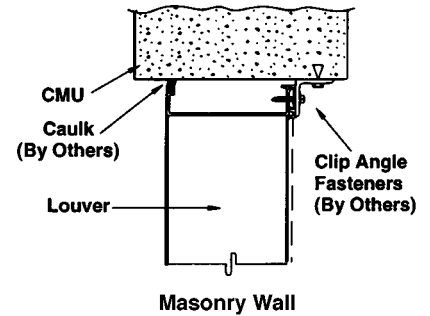

FRAME CONSTRUCTION (Specify one)

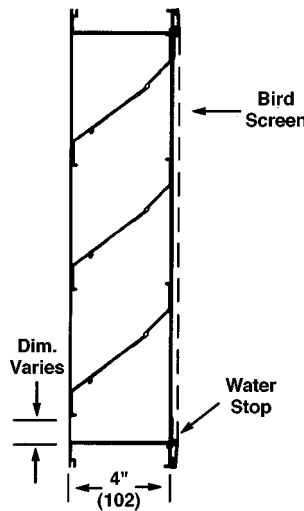
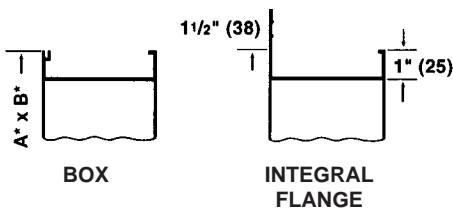

Dimensions in parenthesis () indicate millimeters.

*Units furnished 1/4" (6) smaller than given opening dimensions.

TAG	QTY.	SIZE		FRAME	VARIATIONS
		A*-WIDE	B*-HIGH		
PROJECT ARCH./ENGR. REPRESENTATIVE				LOCATION CONTRACTOR DATE	

FREE AREA GUIDE

Free Area Guide shows free area in ft² and m² for various sizes of GFL800.

Height – Inches and Meters	12	18	24	30	36	42	48	54	60
	0.30	0.46	0.61	0.76	0.91	1.07	1.22	1.37	1.52
12	.17	.27	.37	.47	.57	.67	.77	.87	.98
0.30	.02	.03	.03	.04	.05	.06	.07	.08	.09
18	.42	.67	.93	1.18	1.44	1.69	1.95	2.20	2.46
0.46	.04	.06	.09	.11	.13	.16	.18	.20	.23
24	.67	1.08	1.49	1.90	2.31	2.72	3.13	3.54	3.95
0.61	.06	.10	.14	.18	.21	.25	.29	.33	.37
30	.91	1.47	2.03	2.59	3.15	3.71	4.27	4.83	5.38
0.76	.08	.14	.19	.24	.29	.34	.40	.45	.50
36	1.12	1.80	2.49	3.17	3.85	4.54	5.22	5.90	6.59
0.91	.10	.17	.23	.29	.36	.42	.48	.55	.61
42	1.28	2.06	2.84	3.62	4.40	5.18	5.96	6.74	7.52
1.07	.12	.19	.26	.34	.41	.48	.55	.63	.70
48	1.53	2.46	3.40	4.33	5.27	6.20	7.10	8.07	9.00
1.22	.14	.23	.32	.40	.49	.58	.66	.75	.84
54	1.78	2.87	3.96	5.05	6.14	7.23	8.32	9.41	10.50
1.37	.17	.27	.37	.47	.57	.67	.77	.87	.98
60	2.03	3.26	4.50	5.74	6.98	8.21	9.45	10.69	11.93
1.52	.19	.30	.42	.53	.65	.76	.88	.99	1.11

Width – Inches and Meters

PRESSURE DROP

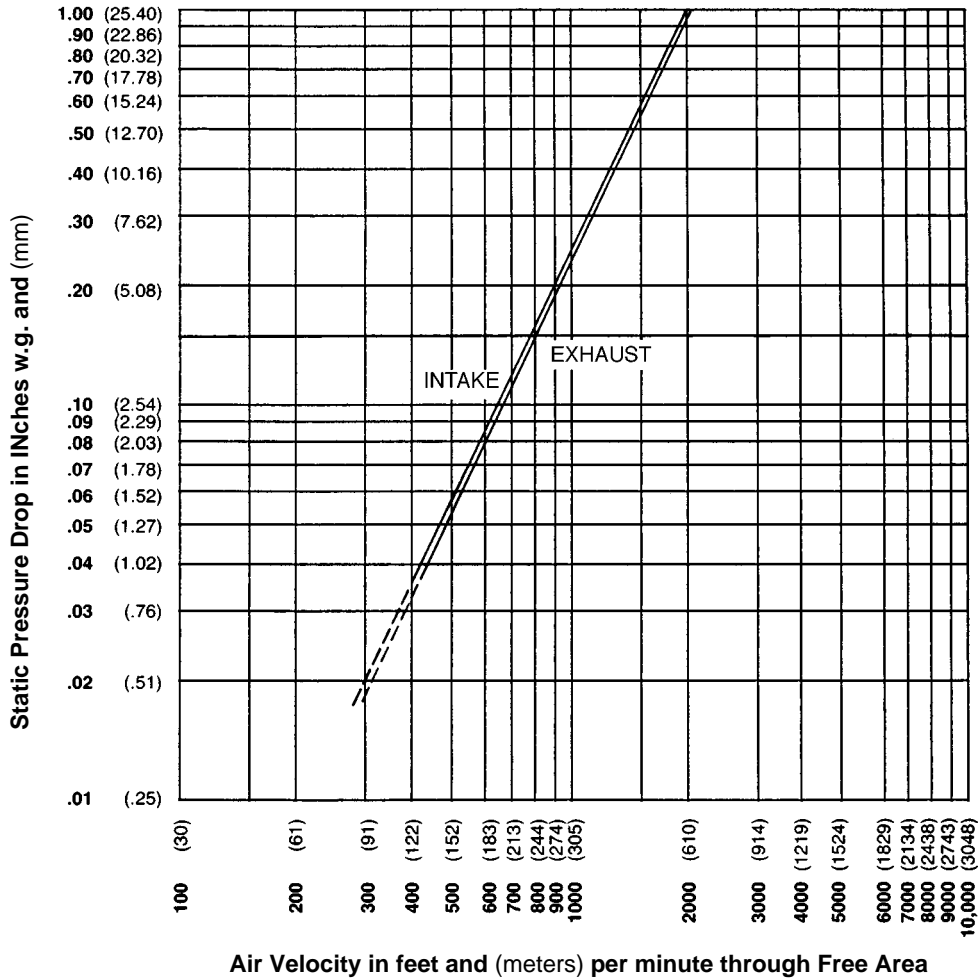

3900 Dr. Greaves Rd.
 Kansas City, MO 64030
 (816) 761-7476
 FAX (816) 765-8955