

L530 STATIONARY LOUVER FORMED STEEL

STANDARD CONSTRUCTION

FRAME

4" (102) deep, 18 gage (1.3) galvanized steel.

BLADES

20 gage (1) galvanized steel, K-style blades (formerly "stormproof") are positioned at 30° angle and spaced approximately 4" (102) center to center.

SCREEN

1/2" mesh x 19 gage (13 x 1.1) galvanized bird screen in removable frame. Screen adds approximately 1/2" (13) to louver depth.

FINISH

Mill.

MINIMUM SIZE

12"w x 8"h (305 x 203).

APPROXIMATE SHIPPING WEIGHT

6 lbs. per sq. ft.

MAXIMUM FACTORY ASSEMBLY SIZE

60"w x 120"h (1524 x 3048).

Louvers larger than the maximum factory assembly size will require field assembly of smaller sections.

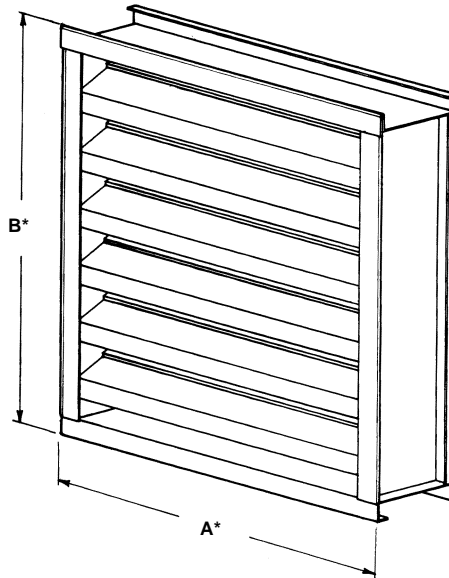

FEATURES

The L530 offers:

- Economical galvanized steel construction.
- High free area, low pressure drop.

VARIATIONS

Variations to the basic design of this louver are available at additional cost. They include:

- Extended sill.
- Hinged frame.
- Front or rear security bars.
- Filter racks.
- A variety of bird and insect screens.
- Selection of finishes: baked enamel (modified fluoropolymer), epoxy, Kynar, Acrodize and prime coat.
- Heavier, 18 gage (1.3) and 16 gage (1.6) construction.

Consult Ruskin for other special requirements.

FRAME CONSTRUCTION

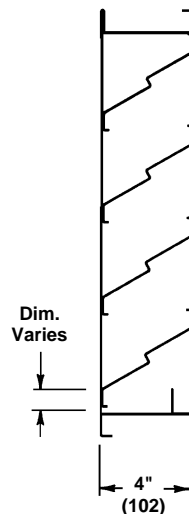
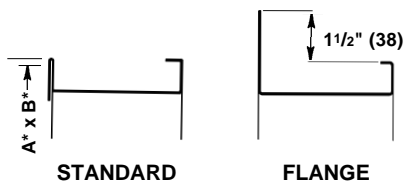

Dimensions in parenthesis () indicate millimeters.

*Units furnished 1/4" (6) smaller than given opening dimensions.

TAG	QTY.	SIZE		FRAME	VARIATIONS
		A*-WIDE	B*-HIGH		
PROJECT ARCH./ENGR. REPRESENTATIVE			LOCATION CONTRACTOR DATE		

TYPICAL INSTALLATION DETAILS

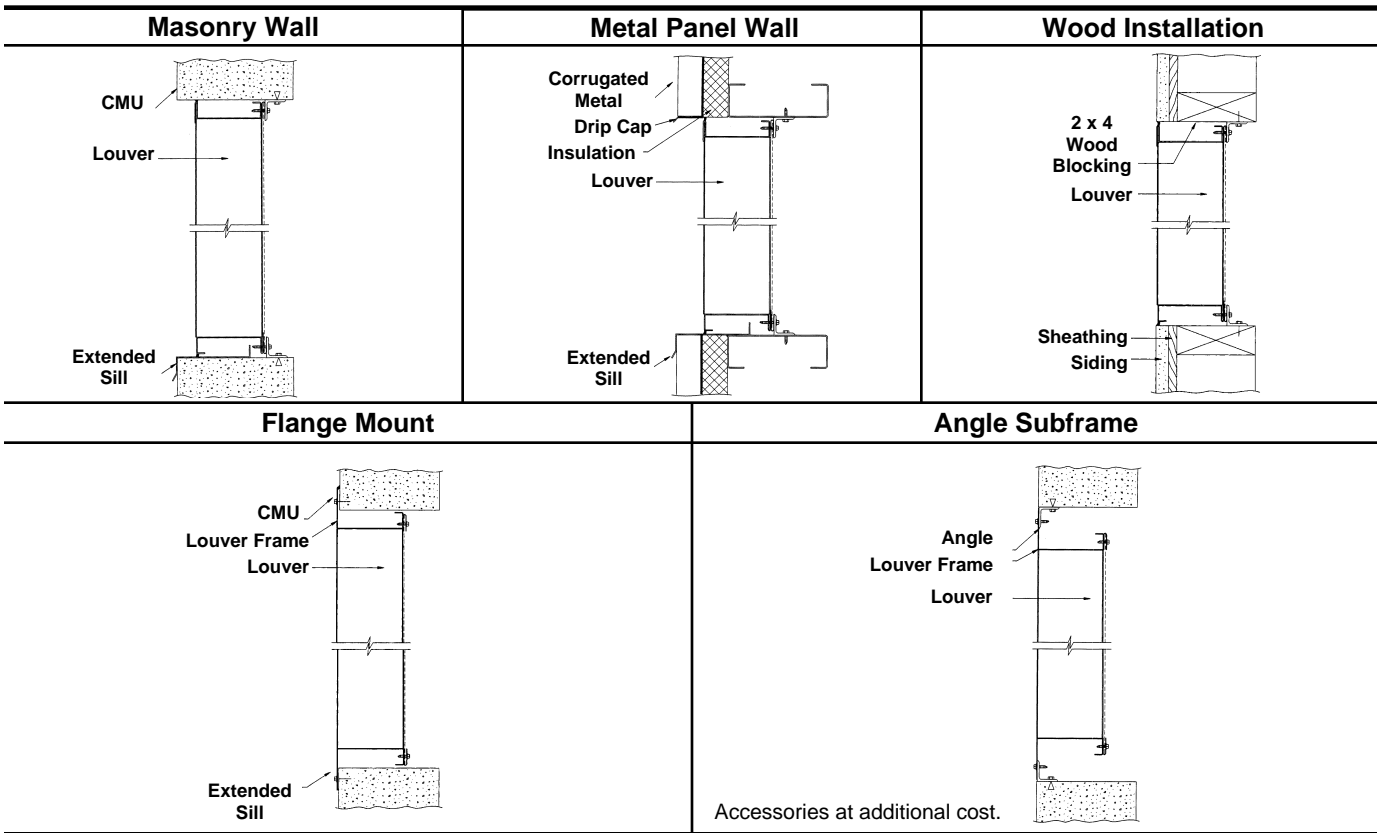

FREE AREA GUIDE

Free area guide shows free area in ft² and m² for various sizes of L530.

Width in Inches and (Meters)

Height in Inches and (Meters)	Width in Inches and (Meters)															
	12 0.30	18 0.46	24 0.61	30 0.76	36 0.91	42 1.07	48 1.22	54 1.37	60 1.52	66 1.68	72 1.83	78 1.98	84 2.13	90 2.29	96 2.44	
12 0.30	0.29 0.03	0.46 0.04	0.63 0.06	0.81 0.08	0.98 0.09	1.15 0.11	1.33 0.12	1.50 0.14	1.67 0.16	1.84 0.17	2.02 0.19	2.19 0.20	2.36 0.22	2.54 0.24	2.71 0.25	
18 0.46	0.47 0.04	0.76 0.07	1.04 0.10	1.33 0.12	1.61 0.15	1.90 0.18	2.18 0.20	2.46 0.23	2.75 0.26	3.06 0.28	3.32 0.31	3.60 0.33	3.89 0.36	4.17 0.39	4.46 0.41	
24 0.61	0.78 0.07	1.24 0.12	1.71 0.16	2.17 0.20	2.64 0.25	3.10 0.29	3.57 0.33	4.03 0.37	4.50 0.42	4.96 0.50	5.43 0.50	5.89 0.55	6.36 0.59	6.82 0.63	7.29 0.68	
30 0.76	0.95 0.09	1.52 0.14	2.09 0.19	2.66 0.25	3.22 0.30	3.79 0.35	4.36 0.41	4.93 0.46	5.50 0.51	6.07 0.60	6.64 0.62	7.21 0.67	7.78 0.72	8.35 0.78	8.91 0.83	
36 0.91	1.26 0.12	2.02 0.19	2.78 0.26	3.54 0.33	4.29 0.40	5.05 0.47	5.81 0.54	6.57 0.61	7.32 0.68	8.08 0.92	8.84 0.82	9.60 0.89	10.35 0.96	11.11 1.03	11.87 1.10	
42 1.07	1.45 0.13	2.32 0.22	3.19 0.30	4.06 0.38	4.93 0.46	5.79 0.54	6.66 0.62	7.53 0.70	8.40 0.78	9.27 11.16	10.14 0.94	11.01 1.02	11.88 1.10	12.75 1.18	13.62 1.27	
48 1.22	1.74 0.16	2.78 0.26	3.82 0.35	4.87 0.45	5.91 0.55	6.95 0.65	8.00 0.74	9.04 0.84	10.08 0.94	11.13 1.03	12.17 1.13	13.21 1.23	14.26 1.33	15.30 1.42	16.34 1.52	
54 1.37	1.94 0.18	3.10 0.29	4.26 0.40	5.42 0.50	6.58 0.61	7.74 0.72	8.90 0.83	10.07 0.94	11.23 1.04	12.39 1.15	13.55 1.26	14.71 1.37	15.87 1.47	17.03 1.58	18.20 1.69	
60 1.52	2.21 0.21	3.54 0.33	4.87 0.45	6.20 0.58	7.52 0.70	8.85 0.82	10.18 0.95	11.51 1.07	12.83 1.19	14.16 1.32	15.49 1.44	16.82 1.56	18.14 1.69	19.47 1.81	20.80 1.93	
66 1.68	2.42 0.22	3.88 0.36	5.33 0.50	6.78 0.63	8.24 0.77	9.69 0.90	11.15 1.04	12.60 1.17	14.05 1.31	15.51 1.44	16.96 1.58	18.41 1.71	19.87 1.85	21.32 1.98	22.78 2.12	
72 1.83	2.69 0.25	4.30 0.40	5.91 0.55	7.52 0.70	9.14 0.85	10.75 1.00	12.36 1.15	13.97 1.30	15.58 1.45	17.20 1.60	18.81 1.75	20.42 1.90	22.03 2.05	23.65 2.20	25.26 2.35	
78 1.98	2.91 0.27	4.66 0.43	6.40 0.59	8.15 0.76	9.89 0.92	11.64 1.08	13.39 1.24	15.13 1.41	16.88 1.57	18.62 1.73	20.37 1.89	22.12 2.06	23.86 2.22	25.61 2.38	27.35 2.54	
84 2.13	3.13 0.29	5.01 0.47	6.89 0.64	8.77 0.81	10.64 0.99	12.52 1.16	14.40 1.34	16.28 1.51	18.16 1.68	20.04 1.86	21.92 2.04	23.79 2.21	25.67 2.39	27.55 2.56	29.43 2.73	
90 2.29	3.40 0.32	5.44 0.51	7.47 0.69	9.51 0.88	11.55 1.07	13.59 1.26	15.63 1.45	17.67 1.64	19.70 1.83	21.74 2.02	23.78 2.21	25.82 2.40	27.86 2.59	29.90 2.78	31.93 2.97	
96 2.44	3.64 0.34	5.82 0.54	8.00 0.74	10.18 0.95	12.36 1.15	14.54 1.35	16.72 1.55	18.90 1.76	21.08 1.96	23.27 2.16	25.45 2.37	27.63 2.57	29.81 2.77	31.99 2.97	34.17 3.18	

SUGGESTED SPECIFICATION

Furnish and install louvers as hereinafter specified where shown on plans or as described in schedules. Louvers shall be stationary type entirely contained within a 4" (102) frame. Louver components (heads, jamps, sills, blades, & mullions) shall be factory assembled by the louver manufacturer. Louver sizes too large for shipping shall be built up by the contractor from factory assembled louver sections to provide overall sizes required. Louver design shall limit span between visible mullions to 5 feet (1524) and shall incorporate structural supports required to withstand a wind load of 20 lbs. per sq. ft. (.96kPa) (equivalent of a 90 mph wind [145 KPH] – specifier may substitute any loading required).

Louvers shall be Ruskin Model L530 construction as follows:

Frame: 18 gage (1.3) galvanized steel.

Blades: 20 gage (1) galvanized steel positioned at 30° angle and spaced approximately 4" (102) center to center.

Screen: 1/2" mesh x 19 gage (13 x 1.1) galvanized bird screen in removable frame.

Finish: Select finish specification from Ruskin/Valspar Finishes Brochure.

RUSKIN®

3900 Dr. Greaves Rd.
Kansas City, MO 64030
(816) 761-7476
FAX (816) 765-8955